

TOOLS NEEDED			
Floor jack	8mm wrench	14mm socket/extension	24mm socket/extension
Needle nose pliers	10mm wrench/socket	17mm wrench/socket	
Protective gloves	12mm wrench/socket	19mm wrench/socket	

1. Step One: LIFT THE KART

In order to assemble the front suspension and steering, the front of the kart must be lifted high enough to install the front tires. We recommend that two people lift the front of the kart while a third person places a rear tire underneath.

2. Step Two: ASSEMBLE FRONT SUSPENSION

- A. Install front shock onto lower A-Arm (GSX only).
- B. Insert bottom stud of strut into square cutout of lower suspension arm. Square of strut and suspension arm MUST be aligned.
- C. Tighten castle nut securely with 19mm wrench/socket and lock with cotter pin and needle nose pliers.
- D. Perform this same procedure on both left and right sides.

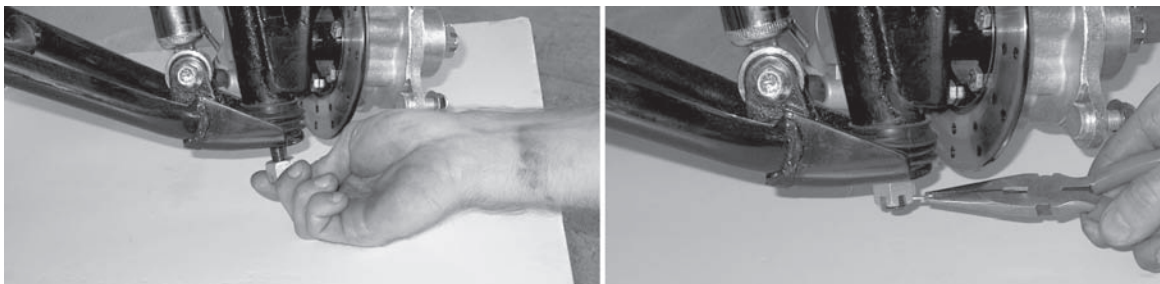

3. ASSEMBLE STEERING LINKAGE

- A. Attach tie rod end to strut by inserting ball joint stud into steering arm of strut.
- B. Place flat washer, then lock washer on stud. Secure with castle nut using 17mm wrench/socket. Lock with cotter pin and needle nose pliers.
- C. Perform this same procedure on both left and right sides.



4. FRONT TIRES

- A. Remove lug nuts from front hub.
- B. Place tire in position by aligning the holes in the wheel with the lugs.
- C. Tighten lug nuts with 14mm socket with extension.
- D. Perform this same procedure on both left and right sides.



5. CARGO RACK

- A. Position the rack so that the inserted ends align with the holes in the frame behind the seat. Tighten with 10mm wrench/socket.
- B. Once in position tighten the rack supports with a 10mm wrench/socket and 12mm wrench/socket.
- C. Install fuel valve lines with fuel filter to the carburetor line (GSX only). See photo.
- D. Install the vacuum line to the (Y) fitting.

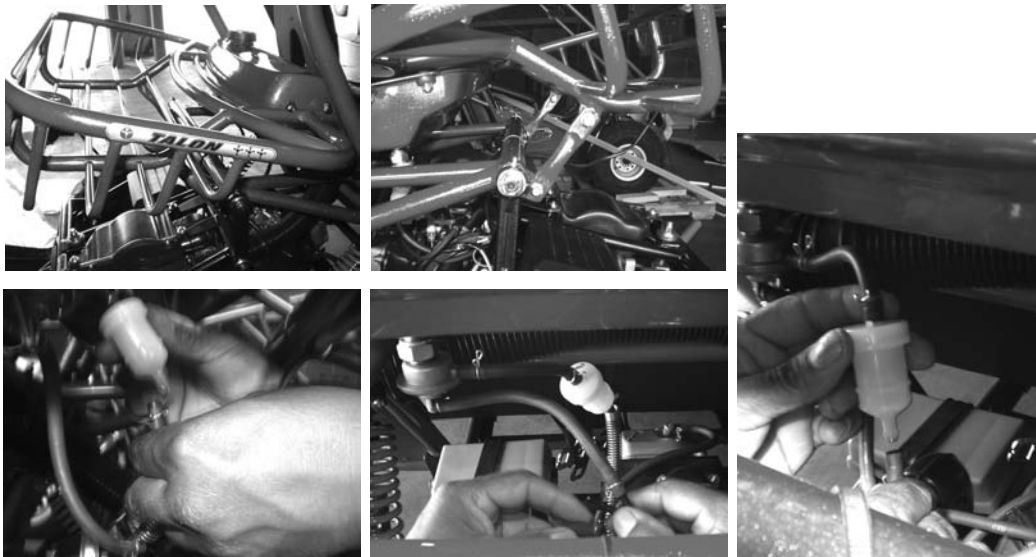

6. REAR SHOCKS

- A. Place floor jack under square tubing located under seat. Lift kart until rear shock mounts align with eyeholes in shock. Insert bolt.
- B. Tighten lock nut using 14mm and 12mm wrenches/sockets.
- C. Perform this same procedure on both left and right sides.



7. REAR TIRE

- A. Slide rear wheel/hub assembly onto axle. Splines must be aligned in order for the assembly to properly fit.
- B. Place small washer, then large washer on axle. Tighten castle nut with 24mm socket with extension.
- C. Lock with cotter pin and needle nose pliers
- D. Perform this same procedure on both left and right sides

**8. SEATS - Install the seat belts before installing the seat (GSX only).**

- A. While holding up on the seat, slide handle with a hammer. Lightly bump the slide back until it stops at this point. See picture.
- B. Repeat on the other side.
- C. Install the seat lock into the frame lock. See picture. Install bolts in rear of seat slide. If there is a misalignment, you can drill to a 3/8" size on frame.

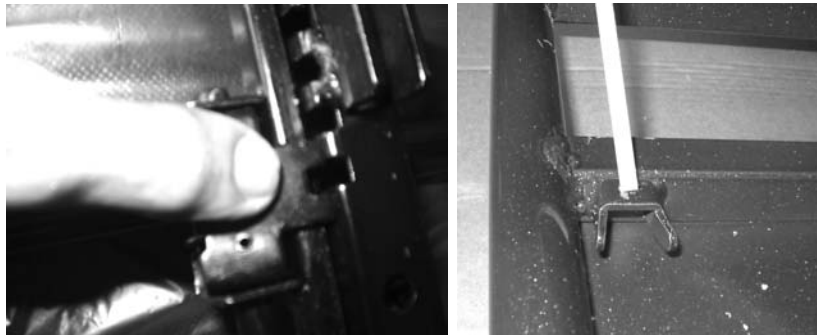
**9. BRUSH BARS**

- A. Place main bars in proper location by putting the open ends over the bar mounts located on the frame.
- B. On each end insert bolt with washer on each side and finger tighten with lock nut.
- C. Place each shoulder bar over the shoulder bar mounts on the frame. Line the holes of the bars up with those of the mounts. Insert bolt with washer on each side and finger tighten with lock nut.
- D. Align the top of the shoulder bars up with the holes in the main bar. Insert a bolt & washer, finger tighten.
- E. Place top cross bar between the main bars with hoop pointing towards the front of the kart. Align holes of the top cross bar with holes in the main bars. Insert a bolt & washer for each hole, finger tighten. Before placing the two cross bars in between, you must use an 8mm tap & chase for the threads & clean the paint/debris out of the bolt holes.
- F. Place bottom cross bar between main bars toward the rear of the kart. Align holes of bottom cross bar with holes in main bars. Insert bolt and washer and finger tighten.
- G. With all members of the brush bar in place, secure tightly with a 10mm & a 12mm wrench/ socket.

9. **BRUSH BARS (Photos Cont.)**



10. **WHEEL CAP**

Place one rubber wheel cap on each wheel.



11. **STEERING WHEEL**

Place the steering wheel on mount, align the holes, tighten with 10mm wrench/socket. Snap steering wheel cap into place.

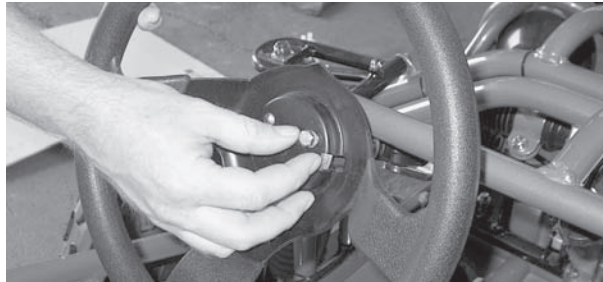

12. **FENDERS**

- A. Install front fenders by inserting the turned down stud of the fender mount into the fender sleeve on the frame.
- B. Insert provided bolt into the mounting hole and tighten the fender to the frame with 8mm and 10mm wrench.
- C. Install the rear fenders to the swing arm by placing the square cut-out ends over the rectangle tubing.
- D. Align the holes of the fender mounts with those of the swing arm, and tighten with 10mm wrench/socket.



13. **HEADRESTS**

Put headrests in designated holes as shown in the picture below.



14. BATTERY

- A. Put on protective gloves.
- B. Remove strip covering acid ports from battery
- C. Place funnel into acid ports on battery. With funnel aligned in battery press acid container firmly into funnel allowing the acid to flow into the battery.
- D. Allow all acid to drain from container.
- E. Place rubber cap into position over the ports, let it sit with cap off for 10 minutes.
- F. Press cap firmly closing all ports securely and let the battery charge for 30 minutes on a 2-3 amp charger with the lid off.
- G. Position battery into battery holder on swing arm.
- H. Place rectangular nuts provided with battery under each post.
- I. Tightly fasten red cable to + pole and black or green cable to - pole.
- J. Place battery cover on top of battery and secure with rubber strap.

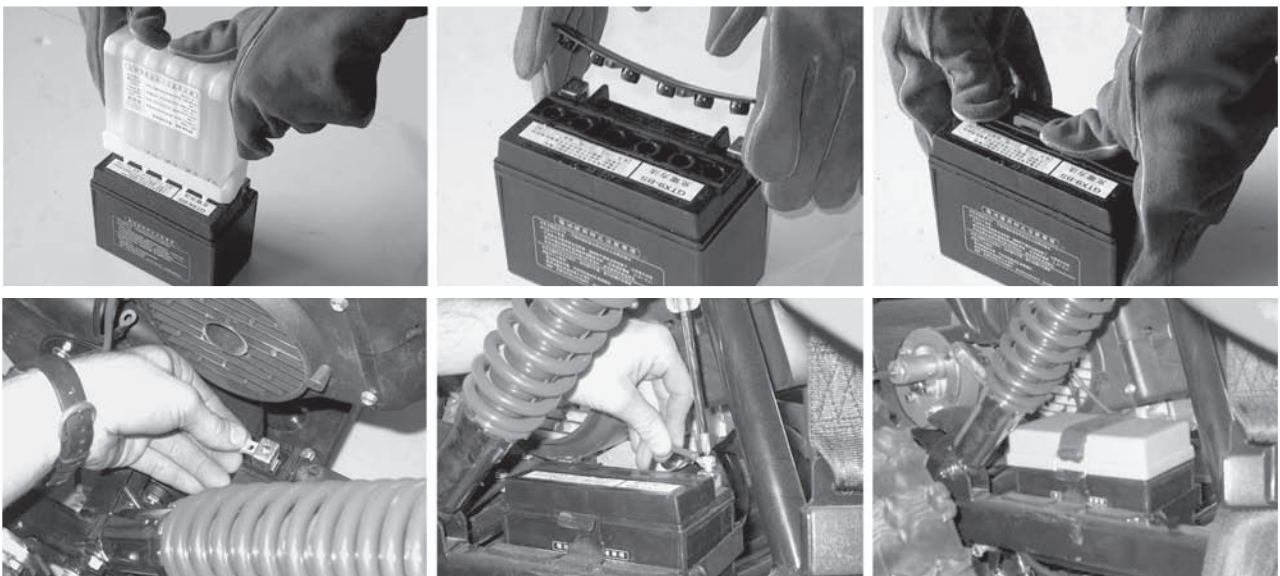

15. TAIL LIGHT

- A. Remove the nut and lock washer from each bolt in tail light.
- B. Mount tail light to kart by inserting the bolts in the tail light through the holes in the bottom crossbar. Tighten with 8mm wrench. Be sure not to over tighten.

